





Detour Plans – Phases 1 and 2

STATE	PROJECT	SHEET NUMBER
VA	VA FLAP NPNWS 105(L)	N23

NOTES:

1. Final location and spacing of signs and devices may be adjusted to fit field conditions as approved by the CO.
2. Install and erect all signs in accordance with the "Virginia Work Area Protection Manual", latest edition, and the "Manual on Uniform Traffic Control Devices", latest edition.

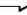
LEGEND

- Proposed Sign Location 
- Barricade Type 3 
- WB Rte. 105 to US 60 WB Detour 
- Closed Ramp 
- Detour Route 

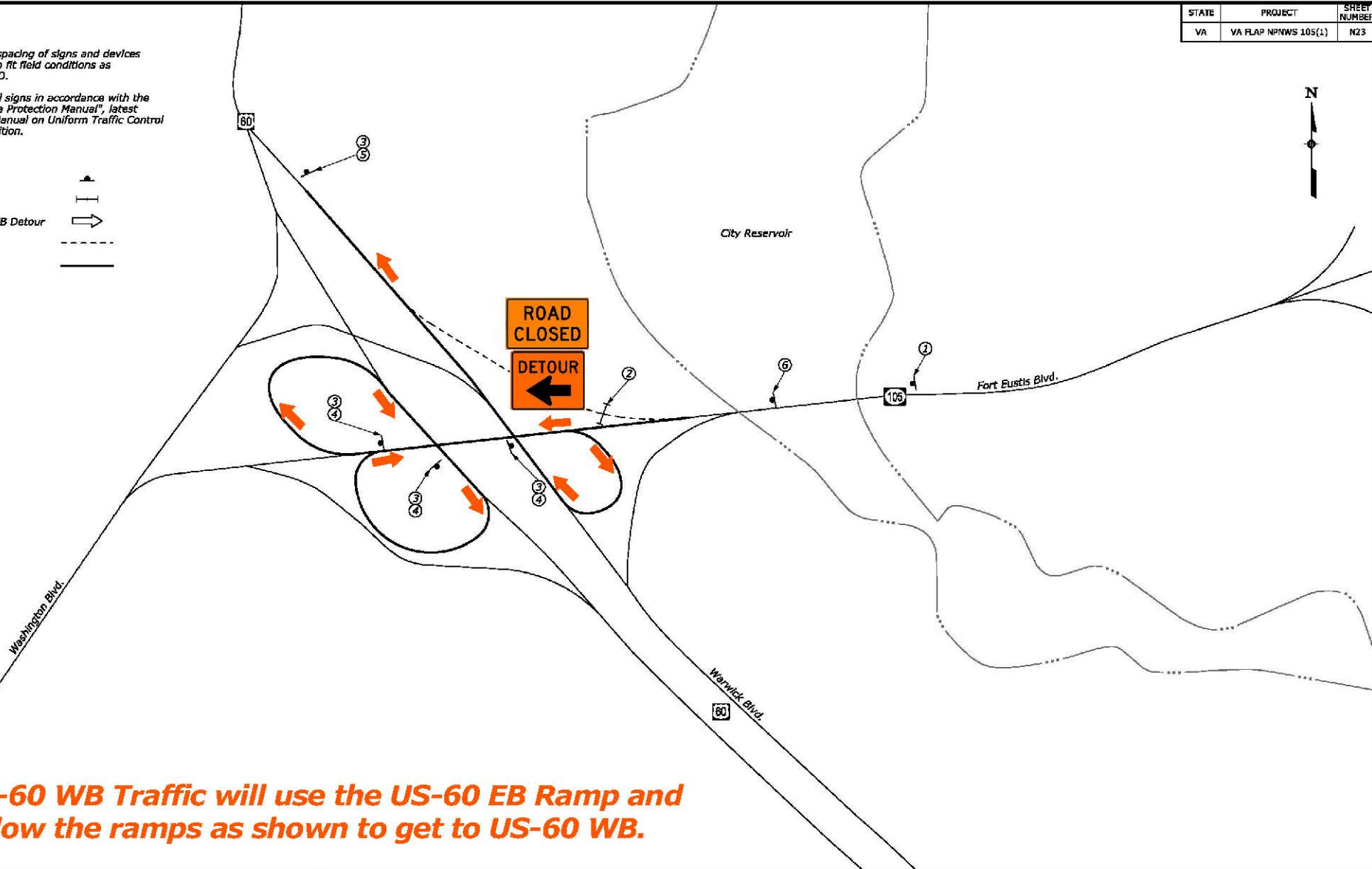

US-60 WB Traffic will use the US-60 EB Ramp and follow the ramps as shown to get to US-60 WB.