

NOTE:

1. The pavement on two- or three-lane roads may remain unmarked up to 14 days when providing signs according to this drawing. Optionally use the vehicle positioning guides to provide additional delineation.
2. On curves with radius less than 500 ft, reduce cycle length to 20 ft.
3. Use permanent markings plan to determine no passing zones for each direction of travel.
4. Repeat R4-1 at 1 mile intervals.
5. Repeat W8-12 after each major intersection and every 2 miles for temporary traffic control zones greater than 3 miles long.
6. Use the PASS WITH CARE (R4-2) sign at the downstream end of a no-passing zone only if a DO NOT PASS (R4-1) sign has been installed at the upstream end of the zone.

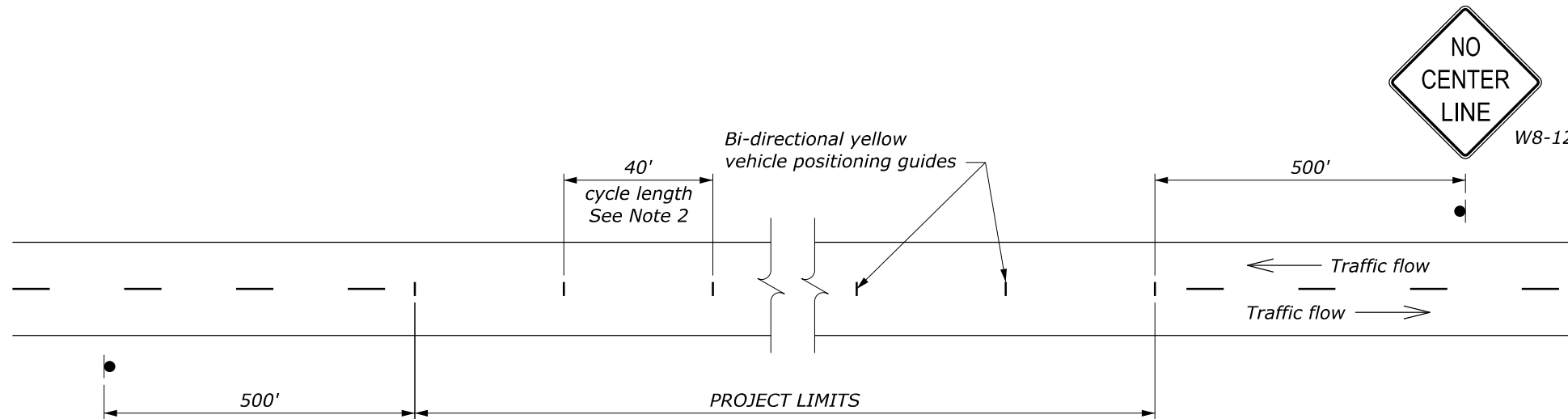

DETAIL A
 Passing zone both directions
 Two-way traffic

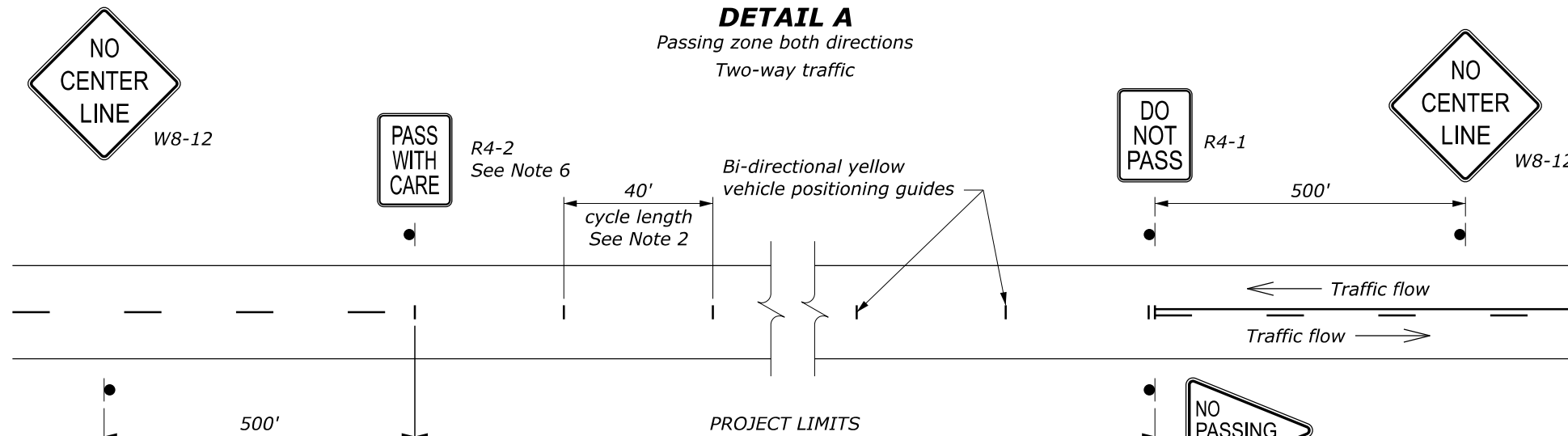

DETAIL B
 No Passing zone one direction
 Two-way traffic

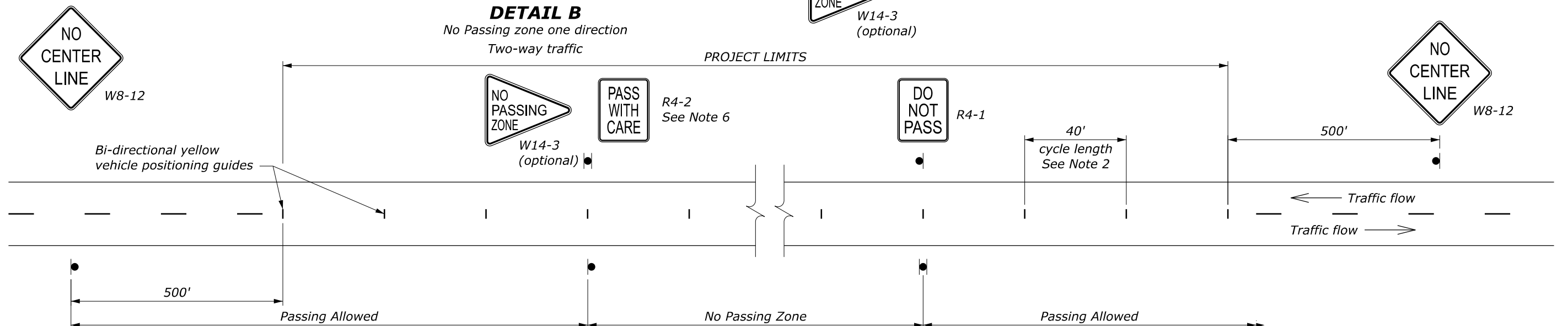

DETAIL C
 No Passing zone both directions
 Two-way traffic

NO SCALE

U.S. DEPARTMENT OF TRANSPORTATION, FHWA OFFICE OF FEDERAL LANDS HIGHWAY	FLH STANDARD 635-3
DELINEATION AND SIGNING FOR UNMARKED PAVEMENTS	SPECIFICATION FP-24, FP-14
	APPROVED FOR USE 2/2024

NOTE:

1. The pavement on two- or three-lane roads may remain unmarked up to 14 days when providing signs according to this drawing. Optionally use the vehicle positioning guides to provide additional delineation.
2. On curves with radius less than 150 m, reduce cycle length to 6 m.
3. Use permanent markings plan to determine no passing zones for each direction of travel.
4. Repeat R4-1 at 1.5 km intervals.
5. Repeat W8-12 after each major intersection and every 3 km for temporary traffic control zones greater than 5 km long.
6. Use the PASS WITH CARE (R4-2) sign at the downstream end of a no-passing zone only if a DO NOT PASS (R4-1) sign has been installed at the upstream end of the zone.

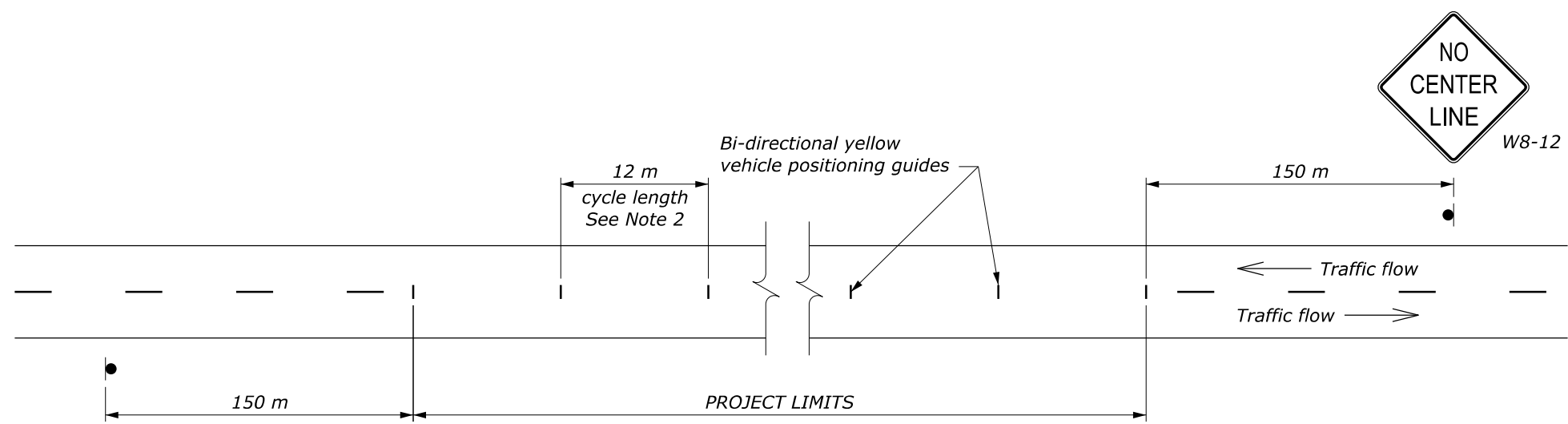

DETAIL A
Passing zone both directions
Two-way traffic

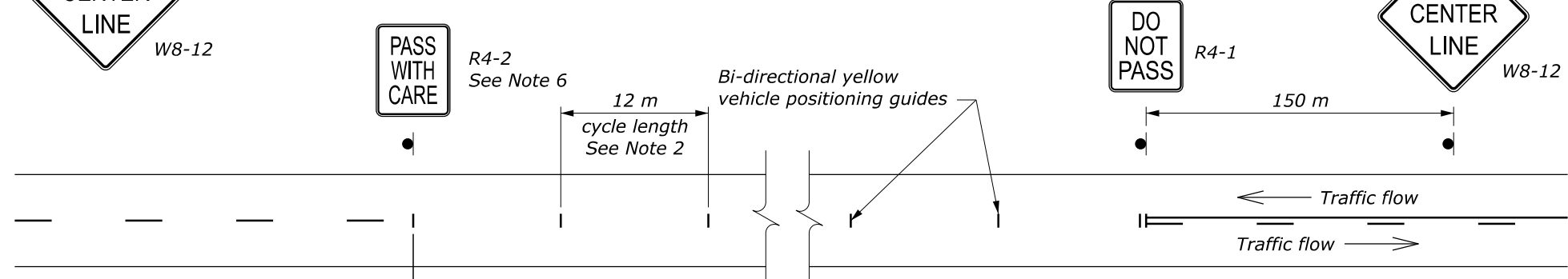

DETAIL B
No Passing zone one direction
Two-way traffic

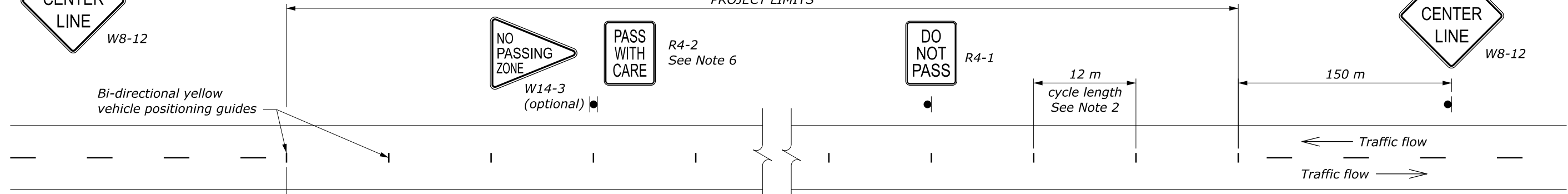

DETAIL C
No Passing zone both directions
Two-way traffic

This drawing contains **Metric** units of measure.
Dimensions without units are millimeters.

U.S. DEPARTMENT OF TRANSPORTATION, FHWA OFFICE OF FEDERAL LANDS HIGHWAY	FLH STANDARD M635-3
DELINEATION AND SIGNING FOR UNMARKED PAVEMENTS	SPECIFICATION FP-24, FP-14
	APPROVED FOR USE 2/2024

NO SCALE